

350mm PRESTRESSED CONCRETE SLAB 09.1412-29 - SAFE LOAD TABLE								14/01/2024
Self Weight 669Kg/m - SAFE LOADS are exclusive of self weight (90mins fire resistance)								
EFFECTIVE SPAN (see fig A for explanation)		PRELIMINARY UNIFORM SAFE LOAD (0 infilled holes)	SHEAR 0 INFILLED HOLES	BEARING 0 INFILLED HOLES	PRELIMINARY UNIFORM SAFE LOAD (2 infilled holes)	SHEAR* 2 INFILLED HOLES	BEARING 2 INFILLED HOLES	9mm TOP WIRES
meters	feet	Kg/m ²	T/panel	mm	Kg/m ²	T/panel	mm	
3.0	9'10"	9,561	17.21	100	12,450	22.41	100	2
3.5	11'6"	8,100	17.01	100	10,576	22.21	100	2
4.0	13'1"	7,004	16.81	100	9,171	22.01	100	2
4.5	14'9"	6,152	16.61	100	8,078	21.81	100	2
5.0	16'5"	5,467	16.40	100	7,200	21.60	100	2
5.5	18'0"	4,909	16.20	100	6,388	21.40	100	2
6.0	19'8"	4,445	16.00	100	5,274	21.20	100	2
6.5	21'4"	4,051	15.80	100	4,407	21.00	100	2
7.0	23'0"	3,714	15.60	100	3,719	20.80	100	2
7.5	24'7"	3,164	15.40	100	3,164	20.60	100	2
8.0	26'3"	2,710	15.19	100	2,710	20.39	100	2
8.5	27'11"	2,333	14.99	100	2,333	20.19	100	2
9.0	29'6"	2,018	14.79	100	2,018	19.99	100	2
9.5	31'2"	1,751	14.59	100	1,751	19.79	100	2
10.0	32'10"	1,523	14.39	100	1,523	19.59	100	2
10.5	34'5"	1,327	14.18	100	1,327	19.38	100	2
11.0	36'0"	1,157	13.98	100	1,157	19.18	100	2
11.5	37'9"	1,008	13.78	100	1,008	18.98	100	2
12.0	39'4"	878	13.58	100	878	18.78	105	2
12.5	41'0"	763	13.38	100	763	18.58	105	2
13.0	42'8"	642	13.18	100	642	18.38	110	2
13.5	44'4"	530	12.97	105	530	18.17	110	2
14.0	45'11"	432	12.77	105	432	17.97	110	2
14.5	47'7"	345	12.57	110	345	17.77	115	2
15.0	49'3"	268	12.37	110	268	17.57	115	2
15.5	50'10"	199	12.17	110	199	17.37	120	2
16.0	52'6"	138	11.96	115	138	17.16	120	2
16.5	54'2"	83	11.76	115	83	16.96	120	2

Notes to Periti: Refer also to guidelines: <http://www.gmfprecast.sandbox.local.com.mt/technical-specs>

- (A) Load tables conforming to *MSA EN 1992-1-1 Eurocode 2: Design of concrete structures - Part 1-1: General rules and rules for buildings*, with both the safe load values satisfying the serviceability limit state (SLS)
- (B) For HC slabs resting on beams, filling of hollows in C30 concrete at supports is recommended.
- (C) The minimum bearing of HC slabs as per table above is to be a minimum of 100mm depending on the loads & strength C30 of padstone suletta, important to have a fair-faced finish to the top surface.
- (D) For all load patterns, eg point loads, these are to be converted to equivalent uniform loads, whilst the **actual** shear load needs to be addressed.
- (E) The selection of *plank* type is the responsibility of the client's *Perit*.
- (F) Embodied carbon is measured per square meter on plan.

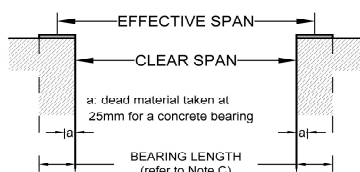

Fig. A

350

Concrete Grade: C45
 Area: 0.273m²
 Hole Area: 0.133m²
 Weight / m: 669kg/m
 R_w: 416mm
 I_{xx}: 374,249cm⁴
 Y_t: 180mm
 Y_b: 170mm
 Embodied Carbon: 122kgCO₂e/m²

