

450mm PRESTRESSED CONCRETE SLAB 09.1112-29 - SAFE LOAD TABLE								01/08/2021
Self Weight 794Kg/m - SAFE LOADS are exclusive of self weight (90mins fire resistance)								
EFFECTIVE SPAN (see fig A for explanation)	PRELIMINARY UNIFORM SAFE LOAD (0 infilled holes)	SHEAR 0 INFILLED HOLES	BEARING 0 INFILLED HOLES	PRELIMINARY UNIFORM SAFE LOAD (2 infilled holes)	SHEAR 2 INFILLED HOLES	BEARING 2 INFILLED HOLES	9mm TOP WIRES	
meters	feet	Kg/m ²	T/panel	mm	Kg/m ²	T/panel	mm	
3.0	9'10"	12,734	19.58	100	16,611	26.56	100	2
3.5	11'6"	10,795	19.36	100	14,119	26.34	100	2
4.0	13'1"	9,342	19.14	100	12,250	26.12	100	2
4.5	14'9"	8,211	18.93	100	10,797	25.91	100	2
5.0	16'5"	7,307	18.71	100	9,634	25.69	100	2
5.5	18'0"	6,549	18.49	100	8,612	25.47	100	2
6.0	19'8"	5,851	18.28	100	7,538	25.26	100	2
6.5	21'4"	5,275	18.06	100	6,318	25.04	100	2
7.0	23'0"	4,791	17.84	100	5,350	24.82	100	2
7.5	24'7"	4,380	17.62	100	4,568	24.60	100	2
8.0	26'3"	3,929	17.41	100	3,929	24.39	100	2
8.5	27'11"	3,399	17.19	100	3,399	24.17	100	2
9.0	29'6"	2,955	16.97	100	2,955	23.95	100	2
9.5	31'2"	2,580	16.76	100	2,580	23.74	100	2
10.0	32'10"	2,259	16.54	100	2,259	23.52	100	2
10.5	34'5"	1,983	16.32	100	1,983	23.30	101	2
11.0	36'0"	1,743	16.10	100	1,743	23.08	103	2
11.5	37'9"	1,535	15.89	100	1,535	22.87	105	2
12.0	39'4"	1,351	15.67	100	1,351	22.65	107	2
12.5	41'0"	1,190	15.45	101	1,190	22.43	109	2
13.0	42'8"	1,046	15.24	103	1,046	22.22	111	2
13.5	44'4"	919	15.02	105	919	22.00	113	2
14.0	45'11"	804	14.80	107	804	21.78	115	2
14.5	47'7"	702	14.58	109	702	21.56	117	2
15.0	49'3"	609	14.37	111	609	21.35	119	2
15.5	50'10"	525	14.15	113	525	21.13	121	2
16.0	52'6"	449	13.93	115	449	20.91	123	2
16.5	54'2"	380	13.71	117	380	20.69	125	2
17.0	55'9"	317	13.50	119	317	20.48	128	2
17.5	57'5"	259	13.28	121	259	20.26	130	2
18.0	59'0"	192	13.06	123	192	20.04	132	2

Notes to Periti: Refer also to guidelines: www.gmfprecast.com

- (A) Load tables conforming to MSA EN 1992-1-2 Eurocode 2: Design of concrete structures - Part 1-1: General with both the safe load values satisfying the serviceability limit state (SLS)
- (B) For HC slabs resting on beams, filling of hollows in C30 concrete at supports is recommended.
- (C) The min. bearing of HC slabs as per table above is to be 100mm up to a max. of 135mm depending on the loads & strength C30 of suletta.
- (D) For all load patterns, eg point loads, these are to be converted to equivalent uniform loads, whilst the **actual** shear load needs to be addressed.
- (E) The selection of *plank* type is the responsibility of the client's *Perit*.

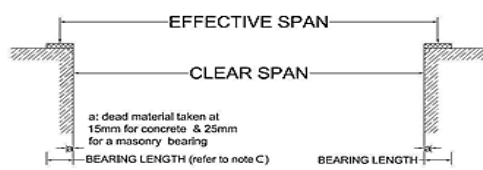

Fig A

450

Concrete grade: C35/45
 AREA: 0.331 Sq.m
 HOLE AREA: 0.0488 Sq.m
 WEIGHT/m: 818 Kg/m
 Bw: 419 mm
 lxx: 807.059 cm²
 Yt: 235mm
 Yb: 225mm

